



FITTING INSTRUCTIONS FITTING INSTRUCTIONS FOR BLGFK0011
BRAKE LEVER-GUARD FITTING KIT
KAWASAKI Z650 2017-



THIS KIT CONTAINS THE ITEMS PICTURED AND LABELLED OVER PAGE.

SOME PARTS MAY BE SHOWN FOR CLARITY OF INSTRUCTIONS ONLY.

DO NOT PROCEED UNTIL YOU ARE SURE ALL PARTS ARE PRESENT.

PLEASE READ ALL INSTRUCTIONS BEFORE PROCEEDING.

**IF IN ANY DOUBT WHEN FITTING OUR PRODUCTS, CONSULT ONE OF OUR DEALERS
OR HAVE FITTED BY A QUALIFIED TECHNICIAN.**

PLEASE NOTE THAT THE WAY THE KIT IS PACKED DOES NOT NECESSARILY REPRESENT THE WAY OF
MOUNTING TO THE BIKE.

IN THE EVENT OF RUBBER WASHERS BEING USED TO HOLD COMPONENTS ONTO BOLTS,
THESE RUBBER WASHERS CAN BE THROWN AWAY.

DIGITAL COPIES OF THESE INSTRUCTIONS ARE AVAILABLE FROM:

WWW.RG-RACING.COM



| <u>TOOLS REQUIRED</u> | <u>GENERAL TORQUE SETTINGS</u> |
|---|---|
| <ul style="list-style-type: none"> • ALLEN TOOL SET TO INCLUDE 5mm A/F SIZE. • SPECIFIC TOOLS REQUIRED TO REMOVE OEM BAR-ENDS, IF APPLICABLE. | M4 BOLT = 8Nm M5 BOLT = 12Nm M6 BOLT = 15Nm M8 BOLT = 20Nm M10 BOLT = 40Nm M12 BOLT = 40Nm |

LEGEND

| ITEM NO. | DESCRIPTION | QTY |
|-----------------|--|------------|
| ITEM 1 | PLG0002COMP BRAKE LEVER GUARD | 1 |
| ITEM 2 | H0056 TAPERED NUT (18-21mm) | 1 |
| ITEM 3 | S0841 CONE SPACER FOR EXPANDER (18-21mm) | 1 |
| ITEM 4 | S0839 17-21mm EXPANDER | 1 |
| ITEM 5 | S1033 SPACER | 1 |
| ITEM 6 | M6 x 1.00 x 90.00mm CAP-HEAD BOLT | 1 |
| ITEM 7 | M6 WASHER OD=12mm | 1 |
| ITEM 8 | NC0008 M6 FLAT CAP | 1 |

EXPLODED ASSEMBLY VIEW

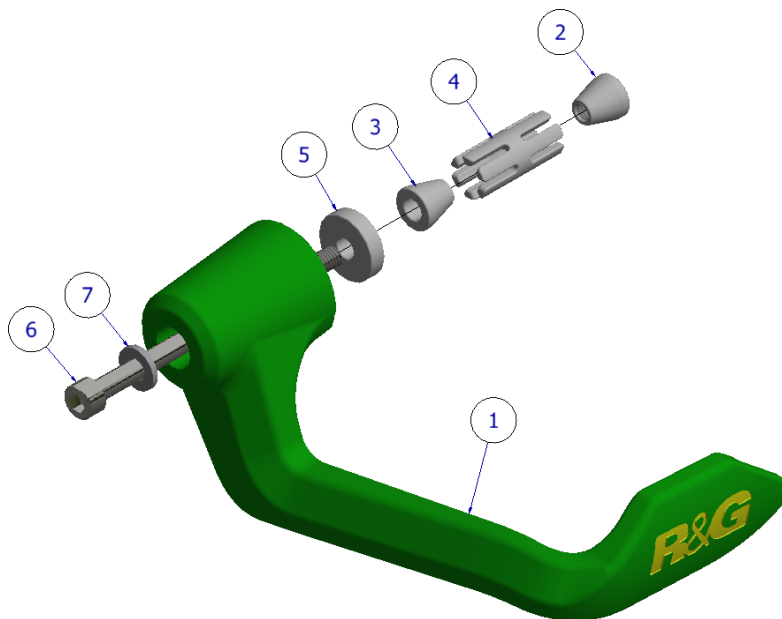

R&G Racing

Unit 1, Shelley's Lane, East Worldham, Alton, Hampshire, GU34 3AQ

Tel: +44 (0)1420 89007 Fax: +44 (0)1420 87301 www.rg-racing.com Email: info@rg-racing.com



PICTURE 1

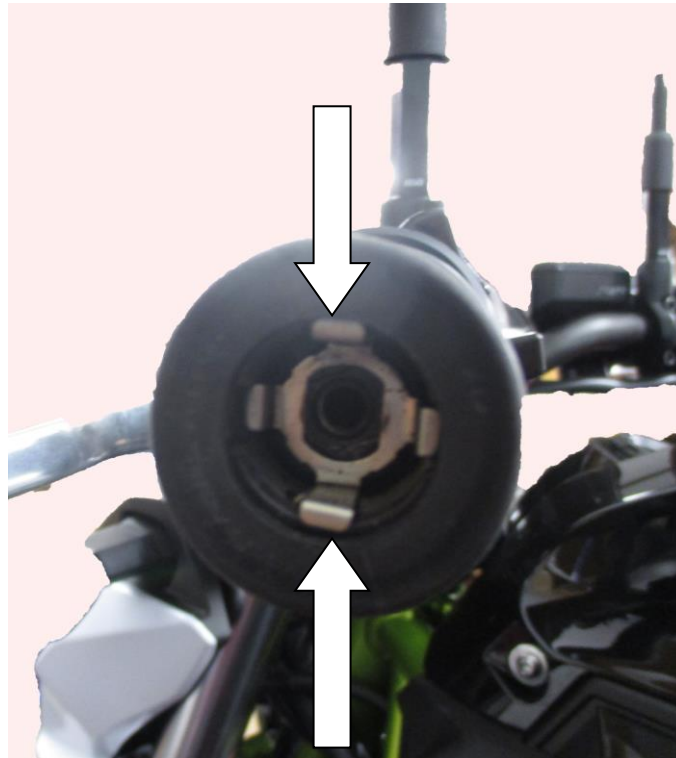

FITTING INSTRUCTIONS

- To fit the Brake Lever Guard, the original bar end needs to be removed. Roll up the end of handle-bar grip inwards so the tip of OEM slider clips can be seen (in the handlebar). Spray the OEM slider assembly with appropriate lubricant, this is to help to slide the whole slider assembly out. Using appropriate tools, please push in the two exposed slider clips inwards as shown in **Picture 1**, while at the same time pulling the bar end/ slider assembly out.
- Place the M6 washer (**item 7**) over the M6 cap-head bolt (**item 6**), then slide through the brake lever guard (**item 1**) so the washer sits against the flat surface within the mounting bore.
- Insert the handle bar spacer (**item 5**) through the protruding end of the bolt, follow by the expander spacer (**item 3**). Ensure that the flat face of the expander spacer sits against the handle-bar spacer.
- Insert the expander (**item 4**) through the protruded end of the bolt, followed by the tapered nut (**item 2**). Ensure that the tapered nut sits in the expander. Do not fully tighten the nut into the expander at this stage.
- Offer the whole assembly into the handlebar until the handle-bar spacer sits against the face of the handlebar tube. Position so when the motorcycle is at full lock in both directions it does not contact any other part of the motorcycle.
- Using a 5mm Allen tool, fully tighten the bolt and check operation.

R&G Racing

Unit 1, Shelley's Lane, East Worldham, Alton, Hampshire, GU34 3AQ

Tel: +44 (0)1420 89007 Fax: +44 (0)1420 87301 www.rg-racing.com Email: info@rg-racing.com



- Finally, push the flat cap (**item 8**) into the head of the cap-head bolt to give a clean look.

IMPORTANT - WHEN FITTING THIS PRODUCT, IT IS YOUR RESPONSIBILITY TO ENSURE THAT THE PRODUCT IN NO WAY IMPEDES THE OPERATION OF THE MOTORCYCLE AND IS CHECKED REGULARLY FOR TIGHTNESS AND CORRECT OPERATION.

FAILURE TO CHECK THE ABOVE COULD RESULT IN SERIOUS INJURY OR DAMAGE.

ISSUE 1 - 07/08/2020 (FB)

CONSUMER NOTICE

The catalogue description and any exhibition of samples are only broad indications of the Products and R&G may make design changes which do not diminish their performance or visual appeal and supplying them in such state shall conform to the order. The Buyer acknowledges no representation or warranty (other than as to title) has been given or will apply to the Products other than those in R&G's order or confirmation and the Buyer confirms it has chosen the Products as being of merchantable quality and suitable for its particular purposes. Where R&G fits the Products or undertakes other services it shall exercise reasonable skill and care and rectify any fault free of charge unless the workmanship has been disturbed. The Buyer is responsible for ensuring that the warranty on the motorcycle is not affected by the fitting of the Products. On return of any defective Products R&G shall at its option either supply a replacement or refund the purchase money but shall not be liable if the Products have been modified or used or maintained otherwise than in accordance with R&G's or manufacturer's instructions and good engineering practice or if the defect arises from accident or neglect. Other than identified above and subject to R&G not limiting its liability for causing death and personal injury, it shall not be liable for indirect or consequential loss and otherwise its liability shall be limited to the amounts paid by the Buyer for the Products or the fitting or service concerned. These terms do not affect the Buyer's statutory rights.

R&G RACING RETURNS POLICY (NON-FAULTY GOODS)

Returns must be pre-authorized (if not pre-authorized the return will be rejected). Goods may only be returned direct to us if they were purchased direct from us (customer must prove if necessary). Otherwise to be returned to original vendor. Goods must be in re-sellable condition, in the opinion of R&G Racing. All returns are subject to a 25% restocking and handling fee (25% of the gross value exc. P&P - at the prevailing price at time of purchase). The customer must pay any and all carriage charges. No returns of discontinued products, unless within 14 days of purchase. This policy does not affect your statutory rights and does not refer to faulty goods.

R&G Racing

Unit 1, Shelley's Lane, East Worldham, Alton, Hampshire, GU34 3AQ

Tel: +44 (0)1420 89007 Fax: +44 (0)1420 87301 www.rg-racing.com Email: info@rg-racing.com



NOTICE DE MONTAGE POUR BLGFK0011
PROTÈGE LEVIER DE FREIN
KAWASAKI Z650 2017-



CE KIT CONTIENT LES ARTICLES ILLUSTRÉS ET ÉTIQUETES SUR LA PAGE.

CERTAINES PARTIES PEUVENT ÊTRE PRÉSENTES UNIQUEMENT POUR LA CLARTE DES INSTRUCTIONS.

NE PAS PROCÉDER AU MONTAGE TANT QUE VOUS N'ÊTES PAS SÛR QUE TOUTES LES PIÈCES SOIENT PRÉSENTES.

VEUILLEZ LIRE TOUTES LES INSTRUCTIONS AVANT DE CONTINUER.

EN CAS DE DOUTE LORS DU MONTAGE DE NOS PRODUITS, CONSULTEZ UN DE NOS REVENDUEURS OU FAITES APPEL A UN TECHNICIEN QUALIFIÉ.

VEUILLEZ NOTER QUE LA FAÇON DONT LE KIT EST EMBALLÉ NE REPRÉSENTE PAS NECESSAIREMENT LA MANIÈRE DE LE MONTER SUR LA MOTO.

SI DES RONDELLES EN CAOUTCHOUC SONT UTILISÉES POUR MAINTENIR LES COMPOSANTS SUR LES BOULONS, ELLES PEUVENT ÊTRE JETÉES.

NOTICE DISPONIBLE AU TÉLÉCHARGEMENT SUR : WWW.RG-RACING.COM



| <u>OUTILS REQUIS</u> | <u>VALEURS DE SERRAGE RECOMMANDÉES</u> |
|--|---|
| <ul style="list-style-type: none"> • CLÉ ALLEN 5mm. • OUTIL SPÉCIFIQUE POUR ENLEVER LES EXTRÉMITÉS DE GUIDON, SI POSSIBLE. | M4 BOULON = 8Nm M5 BOULON = 12Nm M6 BOULON = 15Nm M8 BOULON = 20Nm M10 BOULON = 40Nm M12 BOULON = 40Nm |

LÉGENDE

| ARTICLE NO. | DESCRIPTION | QTÉ |
|--------------------|---|------------|
| ARTICLE 1 | PLG0002COMP PROTÈGE LEVIER DE FREIN | 1 |
| ARTICLE 2 | H0056 ÉCROU CONIQUE (18-21mm) | 1 |
| ARTICLE 3 | S0841 ENTRETOISE CONIQUE POUR EXPANSEUR (18-21mm) | 1 |
| ARTICLE 4 | S0839 17-21mm EXPANSEUR | 1 |
| ARTICLE 5 | S1033 ENTRETOISE | 1 |
| ARTICLE 6 | M6 x 1.00 x 90.00mm BOULON | 1 |
| ARTICLE 7 | M6 RONDELLE OD=12mm | 1 |
| ARTICLE 8 | NC0008 M6 CAPUCHON PLAT | 1 |

SCHÉMA D'ENSEMBLE

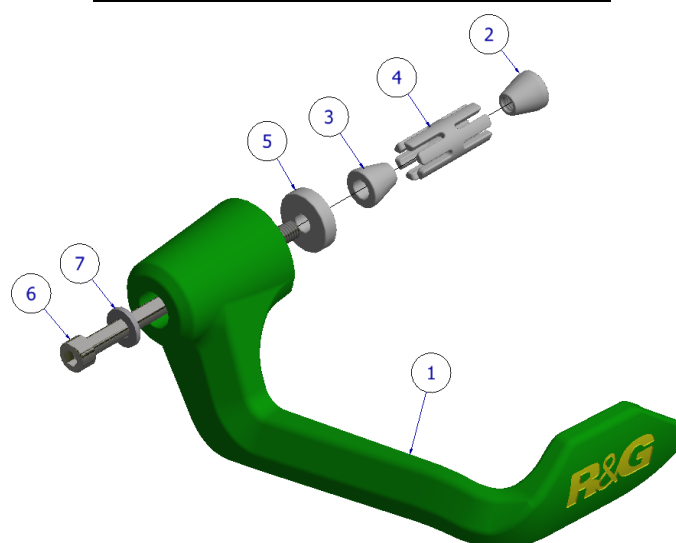

R&G Racing

Unit 1, Shelley's Lane, East Worldham, Alton, Hampshire, GU34 3AQ

Tel: +44 (0)1420 89007 Fax: +44 (0)1420 87301 www.rg-racing.com Email: info@rg-racing.com



NOTICE DE MONTAGE

- Pour installer le protège levier de frein, l'extrémité de guidon d'origine doit être retirée. Enrouler l'extrémité de la poignée du guidon vers l'intérieur pour que la pointe des clips de glissière d'origine soit visible (dans le guidon). Vaporisez l'ensemble de la glissière d'origine avec un lubrifiant approprié, cela aide à faire glisser l'ensemble vers l'extérieur. En utilisant les outils appropriés, veuillez pousser les deux clips de glissière exposés vers l'intérieur comme indiqué sur l'image 1, tout en tirant simultanément sur l'assemblage d'extrémité de guidon.
- Placez la rondelle M6 (article 7) sur le boulon à tête cylindrique M6 (article 6), puis faites-la glisser à travers le protège-levier de frein (article 1) de sorte que la rondelle repose contre la surface plane dans l'alésage de montage.
- Insérer l'entretoise du guidon (article 5) à travers l'extrémité saillante du boulon, puis l'entretoise d'extension (article 3). Assurez-vous que la face plate de l'entretoise d'expansion repose contre l'entretoise du guidon.
- Insérez l'expandeur (article 4) à travers l'extrémité saillante du boulon, suivi de l'écrou conique (article 2). Assurez-vous que l'écrou conique se trouve dans l'expandeur. Ne serrez pas complètement l'écrou dans l'expandeur à ce stade.
- Présentez l'ensemble dans le guidon jusqu'à ce que l'entretoise du guidon repose contre la face du tube du guidon. Positionner de sorte que lorsque la moto est complètement verrouillée dans les deux sens, il n'entre en contact avec aucune autre partie de la moto.
- À l'aide d'une clé Allen de 5 mm, serrez complètement le boulon et vérifiez le fonctionnement.
- Enfin, poussez le capuchon plat (article 10) dans la tête du boulon à tête cylindrique pour donner un aspect net.

IMPORTANT - LORS DE L'INSTALLATION DE CE PRODUIT, IL EST DE VOTRE RESPONSABILITÉ DE VOUS ASSURER QUE LE PRODUIT N'EMPÊCHE EN AUCUN CAS LE FONCTIONNEMENT DE LA MOTO ET SOIT CONTRÔLÉ RÉGULIÈREMENT POUR SON SERRAGE ET SON BON FONCTIONNEMENT.

NE PAS VÉRIFIER CELA POURRAIT ENTRAÎNER DES BLESSURES OU DES DOMMAGES GRAVES.

ISSUE 1 - 07/08/2020 (FB)